

PRODUCT FILE

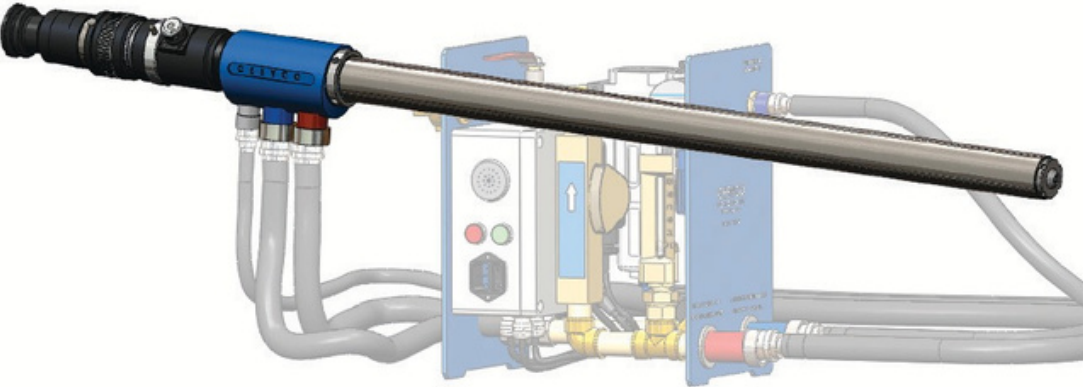

+ Allows the rotation of the water jacket without rotating the hoses.

The endoscope HTO 38 CESYCO is rather aimed for inspections of high temperature furnaces where the light is high. Its small diameter, its lightness and the fact that it is extremely handy allow it to use it as a portable endoscope ; however it can be used as a stationary endoscope.

The endoscope HTO 38 provides a high quality of images with its objective lenses transmission. The observation of the furnace is possible to the naked eyed but a video or a camera can be adapted to record the images. With the rotation of its cooling jacket, the endoscope HTO 38 is very easy to use and matches the furnaces whose temperature can reach up to 2 000°C. The endoscope HTO 38 is available in different lengths. It is equipped with different exchangeable objective lenses which allow to change its direction of view.

Exchangeable objective lenses

The **direction of vision** is the axis the endoscope looks towards. It can be axial or lateral.

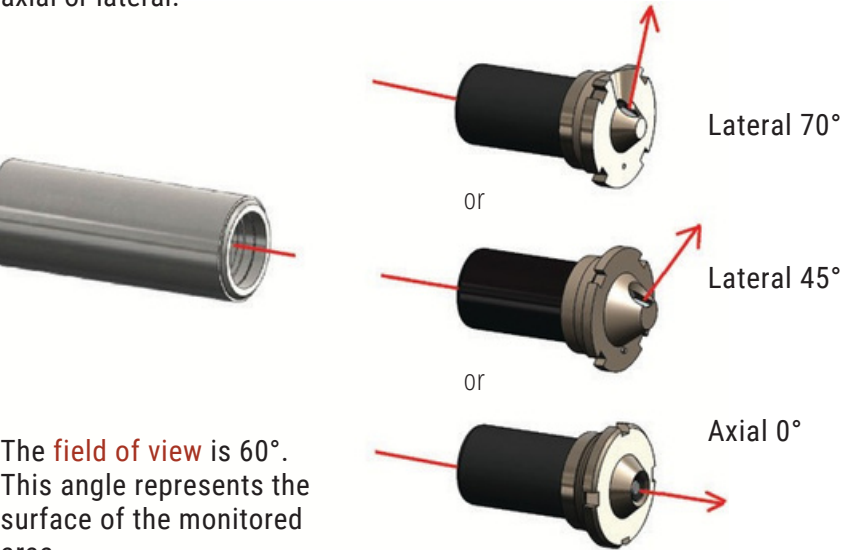

The **field of view** is 60°. This angle represents the surface of the monitored area.

HTO-38	Optical Furnace Borescope	 38mm	
High temperature borescope design, production, sales and services on site		 2,000°C	

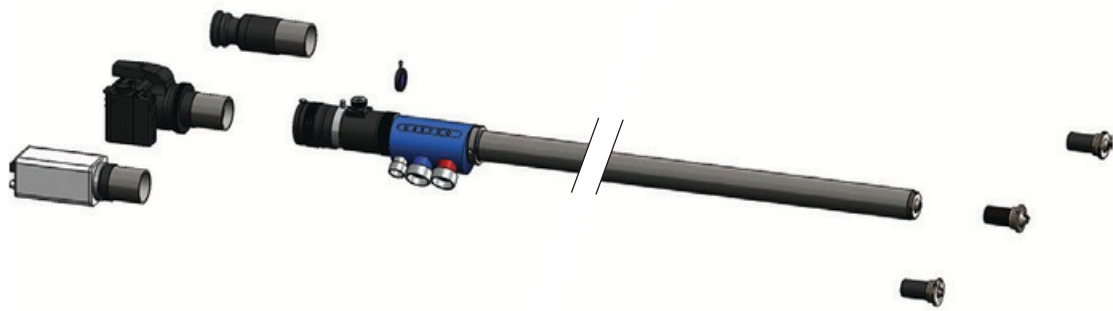

The **objective lenses** are separate optic systems which allow to change the direction of vision of the endoscope.



The **adapters** are additional optic systems to the objective lens. They allow the image transfer to the naked eye or the ccd sensor.



Eyepiece
See to the naked eye

Camera
See and take HD pictures

Video
See and record videos

ACCESSORIES

Contorl Station for monitoring of the fluids which triggers the alarm in case of dysfunction.



Technologies	Full image transmission	Optical
	Cooling system	Triple jacket
Using temperature	From 750°C to 2,000°C	
Dimensions	Diameter	38mm
	Length	900mm to 1,200mm
	Weight	7kg
Cooling system	Water	Loop System
	Air	Lost
Water Housing	Rotation	Free on 360°
Objective lenses	Exchangeable DOV	0° - 45° - 70°
	FOV	60°
Focus	Focusing ring	From 10cm to infinity
Iris	Mechanical	From 0.5mm to full opening
Connections	Inlet/Outlet	Water: BSP 1/2"
		Air: BSP 3/8"
Accessories	Naked eye	Eyepiece
	Video adaptor	C/CS Mount
	Camera adapter	T2 ring for DLSR
	Filters	Grey and Colored
	Focal enlarger	2 X enlarger FOV 30°
	Control and security	Safety station
		Extraction bench